



NC-Cylinder Elf-IV-C

High speed thermos cup digital inkjet UV printer

Nuocai studies the high-speed thermos cups inkjet printer independently, which can realize 360 degree rotation printing. Seamless, 5D relief and high-drop are all available. The printing speed can reach up to 30 seconds/pc.

Product features



High precision and bright colors

NC-Cylinder Elf-IV-C adopts 3 RICOH GEN5I printheads with reasonable function distribution, high precision and long service life, 4 color + white + varnish.



High drop printing creates more powerful shapes

It supports 13mm high height printing, and the laser automatically measures the product size to achieve precise positioning and easily and perfectly print irregularly shaped products.



Large-size printing creates more possibilities

The printing length is 80-280mm and the printing diameter is 45-160mm, which can meet the needs of various types of products such as thermos cups and pots, cylindrical electronic products, wine bottles, etc., and has a wide range of applications.



Fast printing speed and stable production

The Fourth-generation digital inkjet printer for thermos cups adopts spiral printing technology and produces 360° white varnish at the same time. The printing speed is as fast as 30 seconds per piece, which is suitable for mass production mode.



The ultimate pursuit of intimate experience

The tilt control button can adjust the tilt according to the shape of the product, reduce the drop, and achieve tilt printing.

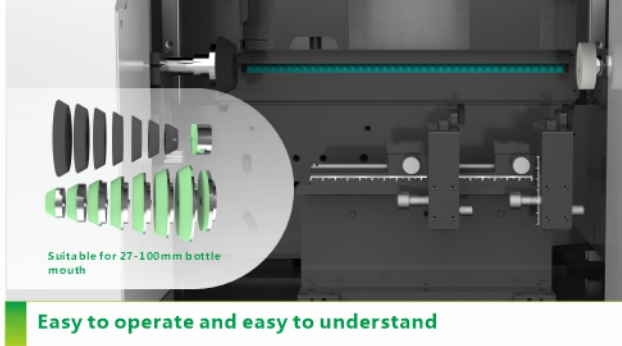

Easy to operate and easy to understand

The multi-diameter cylindrical jig can meet the printing needs of a variety of products. The bottle adjusting jig is equipped with scale adjustment for more convenient operation.

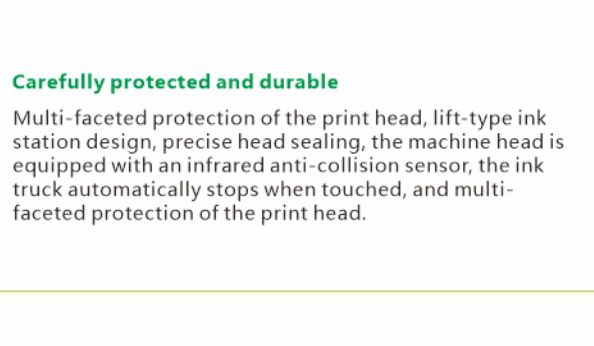
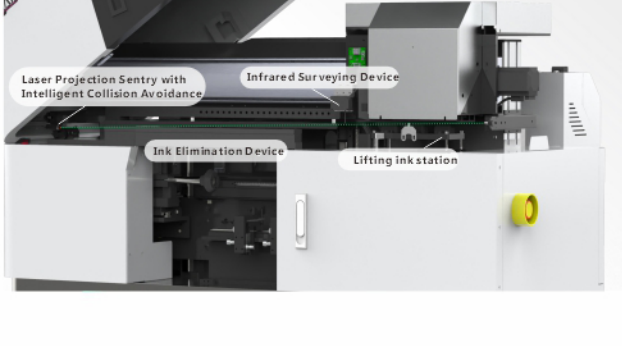

Carefully protected and durable

Multi-faceted protection of the print head, lift-type ink station design, precise head sealing, the machine head is equipped with an infrared anti-collision sensor, the ink truck automatically stops when touched, and multi-faceted protection of the print head.

Diverse effects

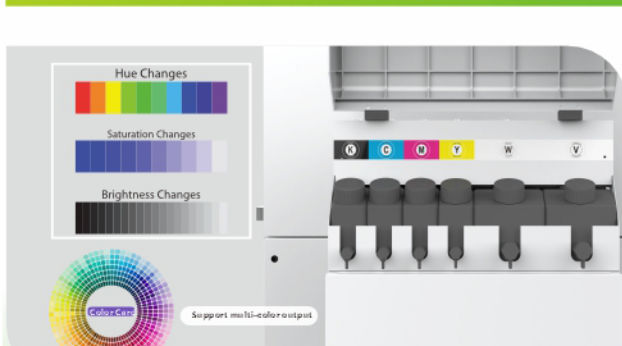

Various colors and stable output

Adopting ICC color control technology, it is not limited by different colors and can easily print multi-color, gradient and other effects. Accurate color control can be achieved during the production process.



Relief technology trend art

NC-Cylinder Elf-IV-C can realize glossy effect partially and fully, with anti-scratch and wear-resistant effect characteristics and highlight the sense of depth.

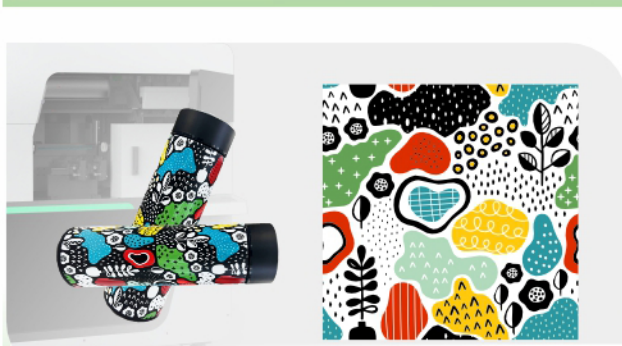

360 degree seamless splicing effect

The software adds a seamless splicing effect, which allows you to easily achieve a seamless splicing effect after setting the size. It is easy to operate and the effect is stunning.

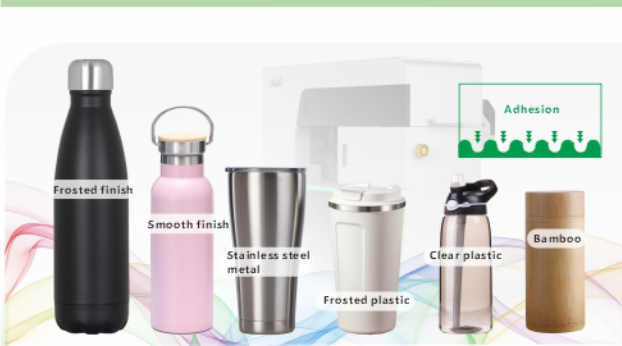

Materials are widely used and have good adhesion

Supports a variety of printing materials, such as frosted/ smooth paint, stainless steel metal, plastic, bamboo, ceramics, wood, etc., with running water UV lamp control technology, segmented temperature control, and adhesion is fully guaranteed.

Applications

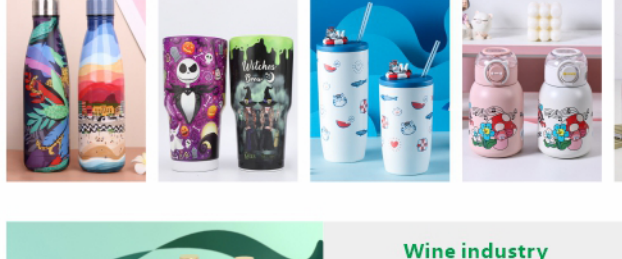

Thermos cup and pot industry

Car cup/Coke cup/Children's cup/Pocket cup/Simmering kettle/Insulated Kettle/Egg cup/Beer cup/Coffee cup/Sports water cup/Straight thermos cup, etc.

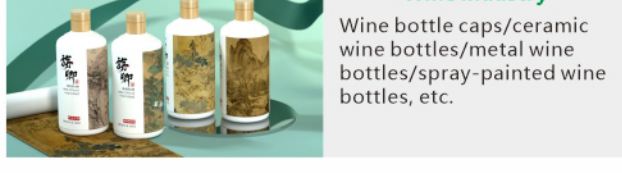

Wine industry

Wine bottle caps/ceramic wine bottles/metal wine bottles/spray-painted wine bottles, etc.

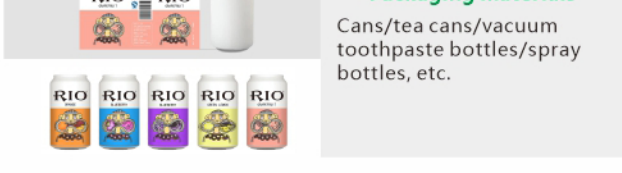

Packaging materials

Cans/tea cans/vacuum toothpaste bottles/spray bottles, etc.

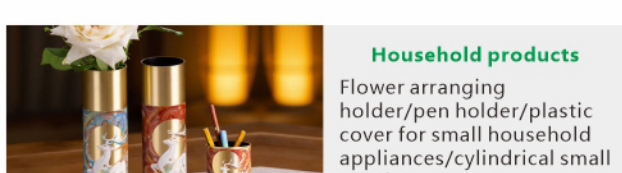

Household products

Flower arranging holder/pen holder/plastic cover for small household appliances/cylindrical small speaker, etc.



Green plant decoration

Ceramic flowerpots/small ceramic vases/cylindrical glass bottles, etc.

Product parameters

		NC-CylinderElf-IV-C
Model number		NC-CylinderElf-IV-C
Print head		RICOH GEN5I*3
Number of nozzles		1280pcs
Max.number of color inks		4 colors
Jetting frequency		Binary mode: 40kHz Grayscale mode: 24kHz
Drop volume		Binary mode: 3pl Grayscale mode: 3-12pl
Nozzle spray force range		2-13mm
Print length		80-280mm
Cylinder/cone printing diameter range		Φ45-160mm
Taper printing range		< 5°
Print version		White and color and varnish print at same time
Print mode		CMYK + W+V
Resolution		720*900dpi/720*1200dpi/960*900dpi/960*1200dpi
Printer dimension	L*W*H	1320mm*915mm*1340mm
Chiller		240KG
N.W. weight		13KG
Packing size	L*W*H	1.897m*1.124m*1.61m
G.W.		370KG
Rip software		RIIIN
Print speed range		30s-3min/个
Graphic format		TIFF/JPG
Connection method		Gigabit Ethernet cable
Power		AC220V, 50HZ/60HZ
Rated power		1500W
Working environment	Temperature	25°C-28°C
	Humidity	35%-65%
Operating conditions	Dust	Avoid dusty environments
	Illumination	Avoid direct sunlight
Ink type		Environmental UV curing ink
UV curing method		Water cooling
Carriage and print head anti-collision		Intelligent anti-collision of laser aiming

Computer configuration requirements:

- Operating system: Windows 10/11(64 bits)
- CPU processor: recommended i5,i7 and above
- Memory: 16G or above recommended
- Displayer: 1920*1080 or higher is recommended
- Hard disk type: 1TB Solid state disk
- Graphics card: Motherboard integrated graphics or independent graphics card(4GB video memory or above)
- Network card: Gigabit network card 1000M

*Computers, computer desks, and machine bases need to be self-provided

